



5 52 050 1430 8

## basis Climbing unit TeenCity Mimas







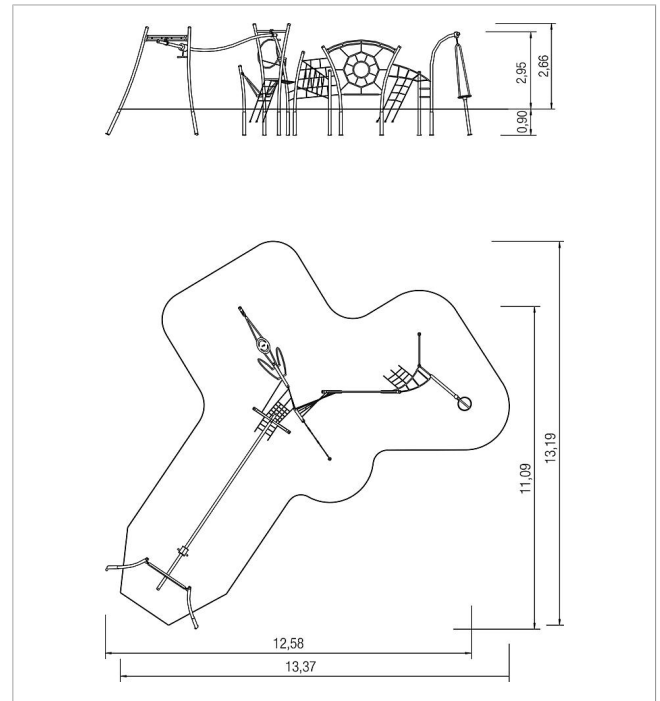

made in germany



### Scope of delivery

- 12x post: galvanised and powdercoated steel
- 1x chain net octagon: stainless steel
- 2x climbing net: plastic coated steel cable
- 1x horizontal bar: stainless steel
- 1x double whisk: stainless steel
- 1x single curver: VA, galvanised steel, rubber
- 1x ladder: stainless steel
- 1x rope ascent: plastic-coated steel cable
- 1x rope element vertical: plastic-coated steel cable
- 1x ladder crossing twisted: stainless steel
- 2x net ascent: plastic-coated steel cable
- 1x overhead monorail: stainless steel
- 11x post cover: PA6



	Material	Steel powder. red
	Minimum space	1500x970x440 cm
	Free falling height	238 cm
	Impact protection net	87,0 m <sup>2</sup>
	Foundations	12x CF
	Assembly	2 Personen/16 Stunden
	Largest section	750x40x30 cm
	Heaviest section	70 kg