

5 67 112 0







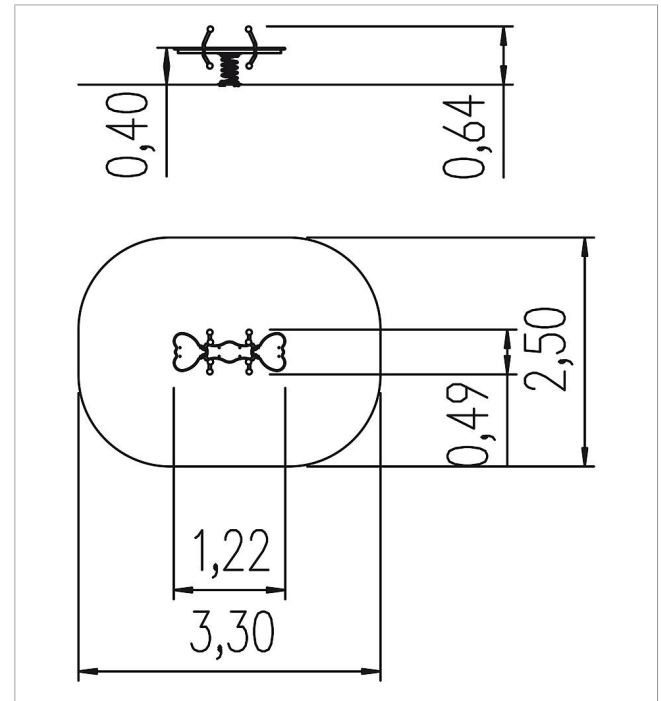

**Basis Double spring  
rocker Flight of the  
Bumble Bee**  
made in germany

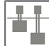

**Scope of delivery**

- 1x spring see-saw-body: powder-coated steel
- 2x seats: PE
- 1x cover panel: PE
- 1x spring: spring steel



	Material	Steel, PE
	Foundation level	FL 3
	Minimum space	330x250x220 cm
	Free falling height	40 cm
	Impact protection net	8,0 m <sup>2</sup>
	Foundations	1x 5591600 + 1x CF or 1x 5632100 + 1x CF
	Assembly	2 persons/1 h
	Largest section	105x95x50 cm
	Heaviest section	20 kg