



5 25 029 0410 0

unique double swing Eagle with swing seats







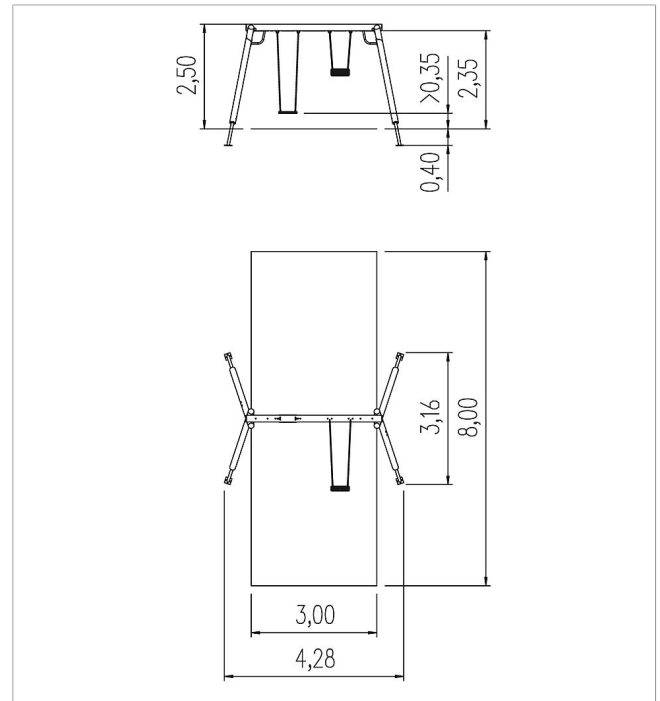

made in germany

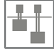

Scope of delivery

- 1x swing frame: SW, galvanised steel
- 2x swing seat with chains: stainless steel, rubber
- 4x swing joint: galvanised steel
- post shoes: galvanised steel

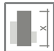

	Material	Larch GL
	Foundation level	FL 1
	Minimum space	800x428x317 cm
	Free falling height	137 cm
	Impact protection net	24,0 m ²
	Foundations	4x CF or 4x PFs
	Assembly	2 persons/3 h
	Largest section	338xØ 14 cm
	Heaviest section	30 kg