



5 55 010 0410 0

unique hexagonal  
system 210







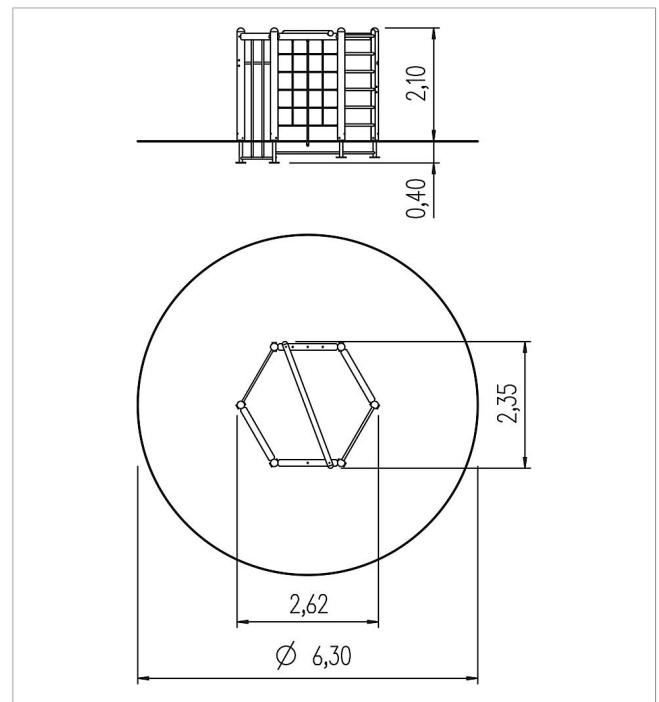

made in germany

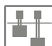

### Scope of delivery

1x rung element: SW, ash  
2x horizontal bar: galvanised and powder-coated steel  
2x fireman"s pole: powder-coated steel  
1x climbing net: polyester-coatedsteel cable  
1x climbing rope: polyester-coatedsteel cable  
wood structure H 200 cm: SW  
post bases: galvanised steel



	Material	Larch
	Foundation level	FL 1
	Minimum space	$\varnothing 630 \times 395$ cm
	Free falling height	205 cm
	Impact protection net	31,5 m <sup>2</sup>
	Foundations	7x CF or 7x PFs
	Assembly	2 persons/3 h
	Largest section	250x139x14 cm
	Heaviest section	120 kg