

5 55 008 0310 0

unique hexagonal  
system 270







made in germany

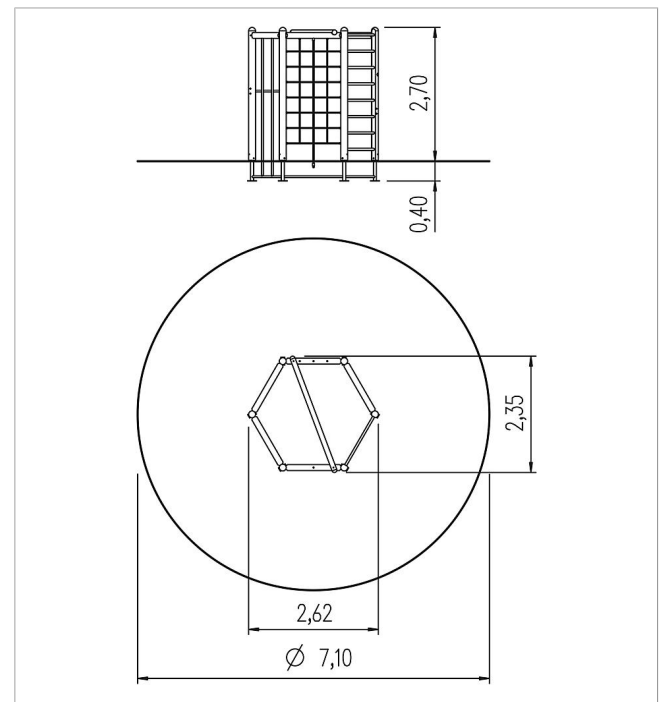

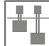
### Scope of delivery

1x rung element: SW, ash  
2x horizontal bar: galvanised and powder-coated steel  
2x fireman"s pole: powder-coated steel  
1x climbing net: polyester-coated steel cable  
1x climbing rope: polyester-coated steel cable  
wood structure H 260 cm: SW  
post shoes: galvanised steel

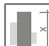

	Material	Larch nature
	Foundation level	FL 1
	Minimum space	Ø 710x445 cm
	Free falling height	265 cm
	Impact protection net	40,0 m <sup>2</sup>
	Foundations	7x CF or 7x PFs
	Assembly	2 persons/3 h
	Largest section	310x139x14 cm
	Heaviest section	140 kg