

5 25 010 0700 0

active trail pile bridge M4

made in germany



Scope of delivery

1x pile chain pre-installed: hardwood oiled, stainless steel
1x holding rope: plastic-coated steel cable

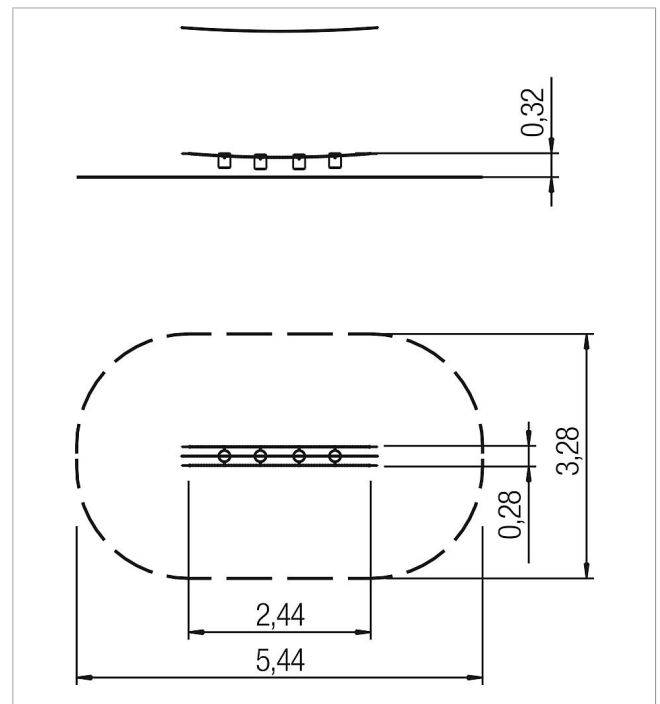

	Material	Eucalyptus
	Foundation level	-
	Minimum space	544x328x214 cm
	Free falling height	32 cm
	Impact protection net	-
	Foundations	-
	Assembly	1 person/1 h
	Largest section	Ø 14x20 cm
	Heaviest section	18 kg