



5 25 095 0110 0

unique play unit
Hardwick Hall, solo







made in germany

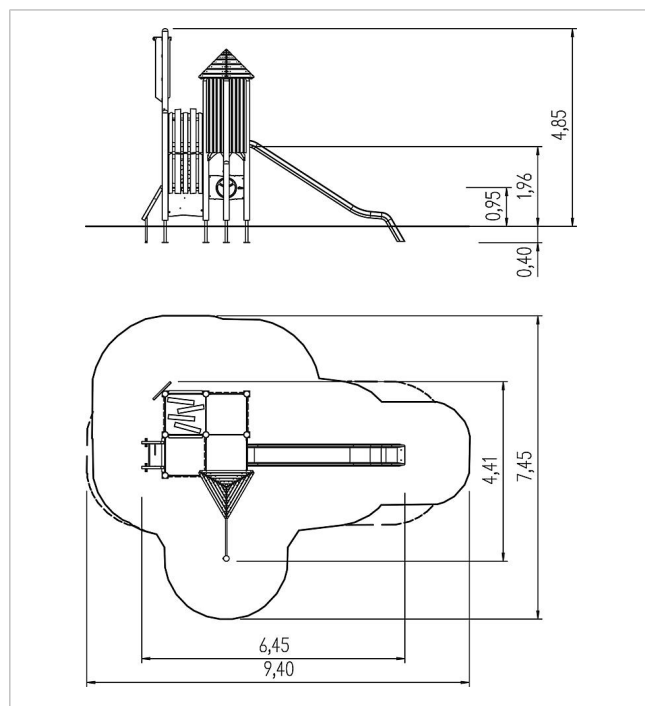

Scope of delivery

- 11x post construction: SW or steel
- 5x platform construction: galvanised steel
- 1x platform squared timber: HPL, SW
- 4x platform: HPL
- 12x wall panel: SW
- 1x climbing wall: HPL, climbing grips
- 1x material ladder: SW, stainless steel, polyester-coated steel cable
- 1x tendril ascent: polyester-coated steel cable, stainless steel
- 2x frame trim: SW
- 1x slide entry plate: HPL
- 1x play panel chaos pendulum: HPL, macrolon, stainless steel
- 1x roof: SW
- 1x decoration flag: HPL
- 3x set of grips: steel



	Material	SW pi
	Foundation level	FL 1
	Minimum space	940x745x585 cm
	Free falling height	195 cm
	Impact protection net	43,0 m ²
	Foundations	13x CF or 12x PFs + 1x CF