



5 11 007 0111 0

playo play unit Leon II, solo





made in germany

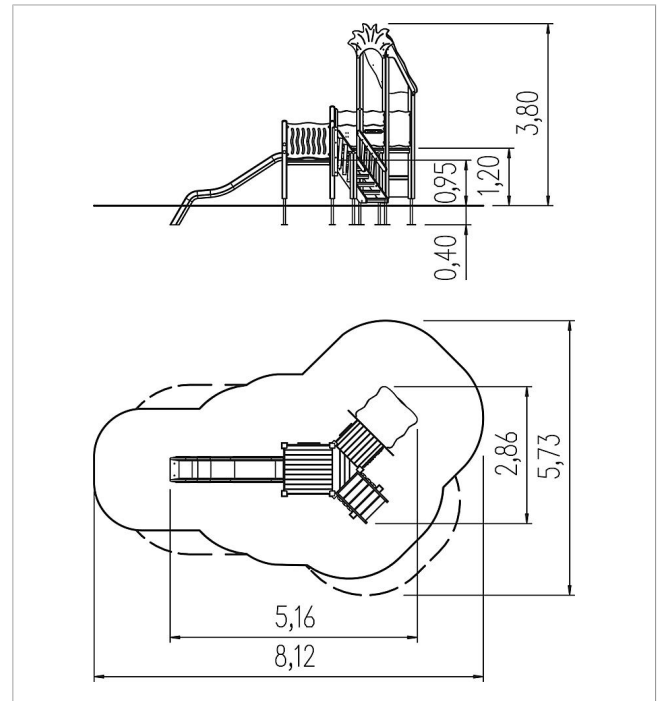

Scope of delivery

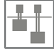
- 11x post construction: SW
- 11x post shoe: steel galvanised
- 4x platform construction: SW
- 2x adapter: SW
- 7x wall panel: HPL
- 1x palm tree roof: HPL
- 1x slide entry plate: HPL
- 1x play panel letter disc: HPL, steel galvanised
- 1x play panel hole: HPL, perspex
- 1x play panel wavy grooves: HPL
- 1x play panel steering wheel: HPL, steel galvanised
- 1x play panel counting rings: HPL, ROB
- 1x counter: SW, HPL
- 1x staircase: SW
- fittings: stainless steel



	Material	SW pi
	Foundation level	FL 1
	Minimum space	812x573x380 cm
	Free falling height	120 cm
	Impact protection net	28,5 m ²
	Foundations	11x CF or 10x PFs