



5 25 147 0110 0

unique play unit Varin,
solo







made in germany

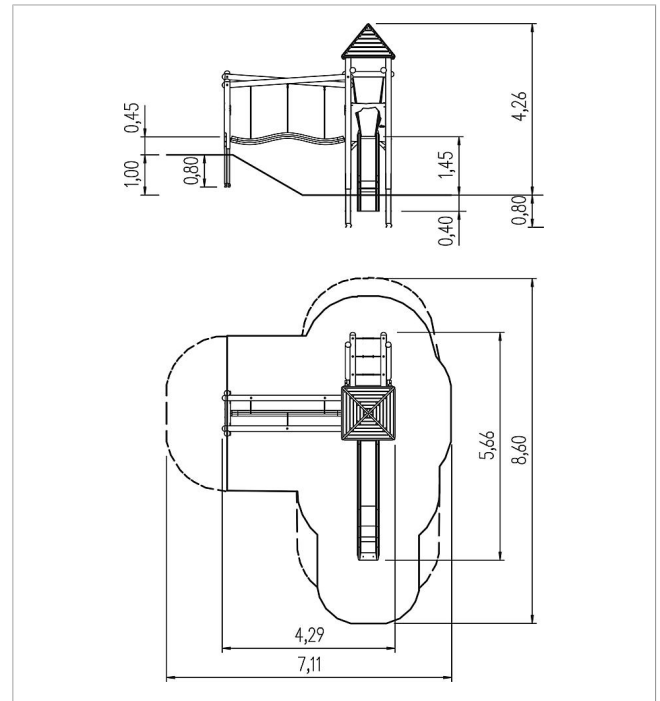

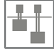
Scope of delivery

- 6x post unit: SW or steel
- 1x platform wood : SW
- 1x roof: SW
- 1x liana ascent: plastic-coated steel rope, SW
- 1x Tibet bridge horizontal: plastic-coated steel tow
- 3x access restriction: HPL
- 1x parapet: SW
- 1x slide entry board: HPL

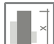

	Material	SW pi
	Foundation level	FL 1
	Minimum space	711x860x426 cm
	Free falling height	145 cm
	Impact protection net	32,0 m ²
	Foundations	7x CF or 2x PFs + 1x PFI + 4x CF
	Assembly	2 Personen/4 Std.
	Largest section	Ø14x381 cm