

5 25 008 0700 0

## active trail suspension bridge M2







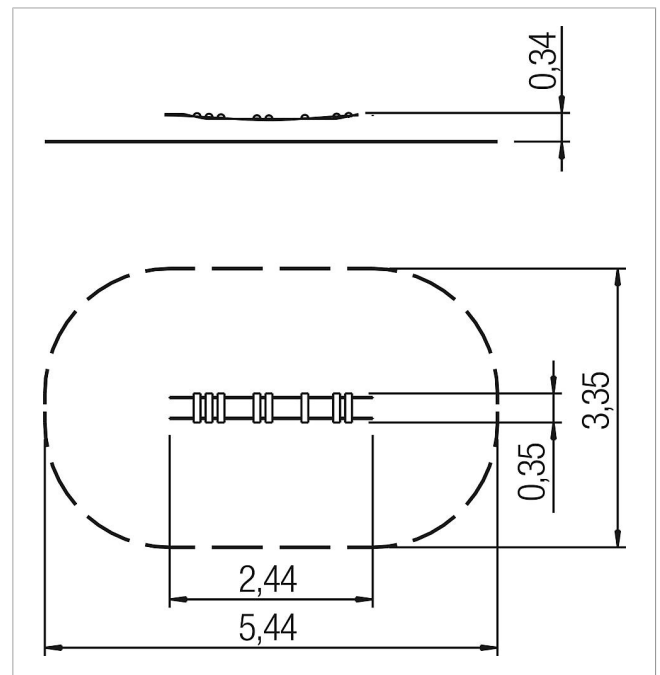

made in germany



### Scope of delivery

1x hanging bridge pre-installed: hardwood oiled, plastic-coated steel cable



	Material	Eucalyptus
	Foundation level	-
	Minimum space	544x335x216 cm
	Free falling height	34 cm
	Impact protection net	-
	Foundations	-
	Assembly	1 person/0.5 h
	Largest section	-
	Heaviest section	8 kg